

## Description:

6 Mil Polyethylene Vapor Barrier, seams taped Vinyl Dura-cushion Pads, stapled to bottom 2"X 3" Pine Sleepers, 4' lengths, 12" on center 1 Layer of 4 ply Douglas Fir, glued & stapled Moistop Vapor Barrier, under flooring 3/4"X 2 1/4" Solid Hard Rock Maple Flooring

## Features & Benefits:

- Quality Materials, no need to replace in 10-20 years
- Superior Craftsmanship, built sturdy, won't fall apart
- All Inclusive Easy to Understand Pricing, simple, less hassles, no nickel and diming
- Lifetime Limited Warranty, no out of pocket repair bills because of faulty materials or workmanship\*  
 (Backed with Over 60 Years Experience)

\*does not cover moisture, maintenance or water related problems



## Specifications:

<b>SYSTEM TYPE</b>	Floating System	<b>SLAB DEPRESSION</b>	3/8" pad: 25/32" flooring – 3 1/8" 33/32" flooring – 3 3/8"	5/8" pad: 25/32" flooring – 3 3/8" 33/32" flooring – 3 5/8"
<b>FLOORING TYPE</b>	Hard Rock Maple or customer choice	<b>TESTING LABORATORY</b>	United States Sports Surfacing Laboratory	
<b>ANCHORAGE</b>	No concrete attachment	<b>CERTIFIED TESTING</b>	Laboratory test equipment	
<b>SUBFLOOR CONSTRUCTION</b>	Plywood Panel	<b>GREEN STATUS</b>	Managed forests, certification available calibrated and certified through the ISSS	
<b>RESILIENCE</b>	PVC Pads			

WALL BASE DETAIL

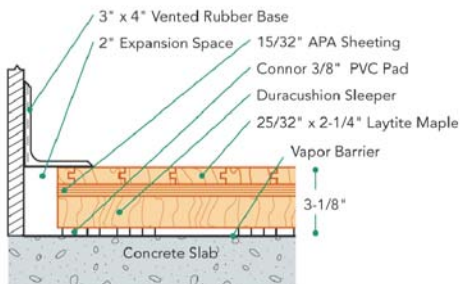

THRESHOLD DETAIL (optional accessory)

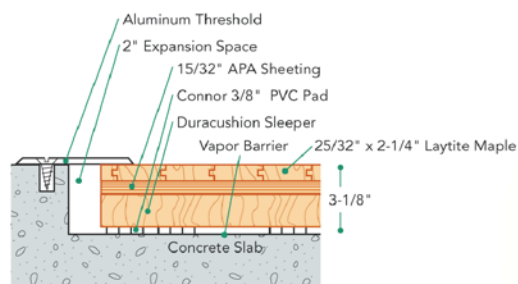

EQUIPMENT DETAIL (optional accessory)

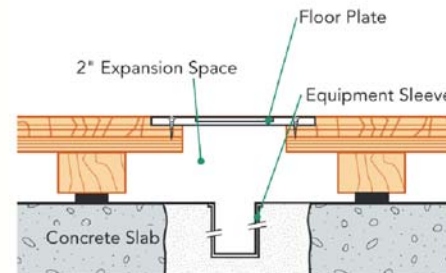

**Tacinelli Sports Floor Systems**  
 P.O. Box 117, Billings, NY 12510  
 1-888-404-WOOD  
 cdtacinelli@tacinelli.com  
 www.bestsportsfloors.com